

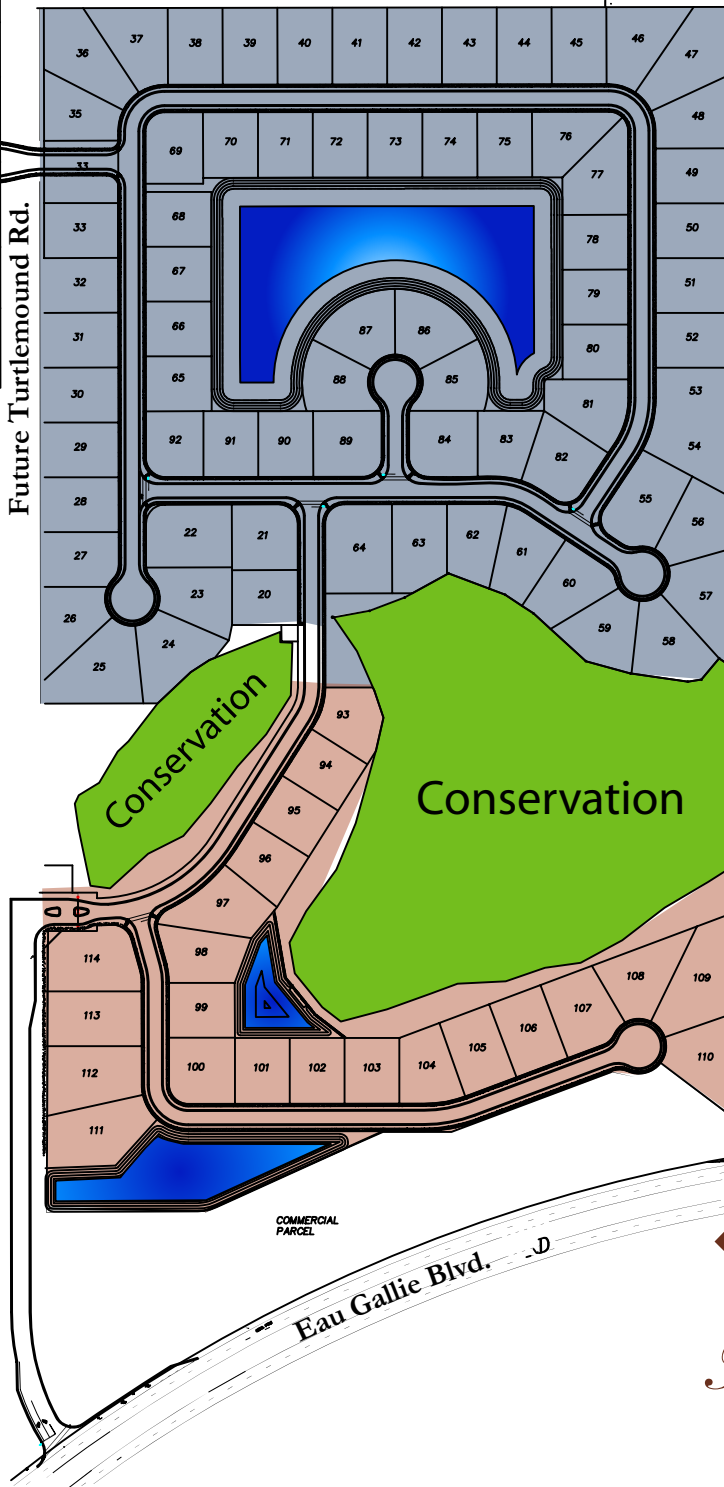

Veranda Place

www.StanleyHomes.com

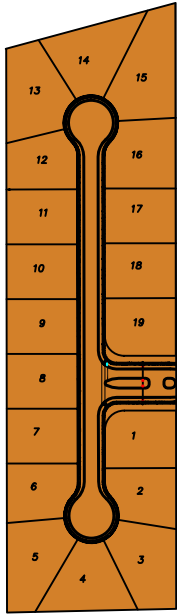

Estates

1750 Sq.Ft a/c minimum
Tile or 30yr. Dimensional Shingle
25' front setbacks

Lakes

2,000 Sq.Ft a/c minimum
Tile or Dimensional Shingle
25' front setbacks

Preserve

2,000 Sq.Ft a/c minimum
Tile or Dimensional Shingle
25' front setbacks

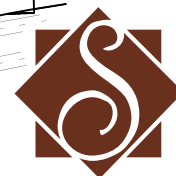

**STANLEY
HOMES**

The choice is yours.

321.610.8674



Veranda Place

Community Highlights

If you've been looking for a spacious, elegant home on an expansive homesite in a beautiful setting, then make Veranda Place your new-home destination.

Veranda Place is nestled in a spectacular tree-lined location, with many of the home-sites backing to lush conservation and lake views. Home sites in Veranda Place range from 1/3 acre to over 1/2 acres and have at least 100 feet of frontage. At Veranda Place homeowners will have the ultimate in privacy and tranquility, yet still be so close to highways, shopping and AAA-rated schools. In fact, we're only 1 mile east of I-95 on Eau Gallie Blvd. for outstanding accessibility.

General Highlights

- 114 Home Sites
- 64 Acres
- Private gated community
- City water & sewer, Gas, and Electric - all underground
- Home Site Size: 1/3 to 1/2 acre
- All Home Sites must be fully irrigated and sodded with Floratam grass.
- Paver driveway and walkways



The choice is yours.

321.610.8674

www.StanleyHomesInc.com

